

# Lesson Observations with HOW2s

Issuing observation grades and targets, on its own, doesn't improve the quality of teaching. Providing teachers with a host of personalised and practical solutions to use immediately, does. HOW2s fulfill this role.

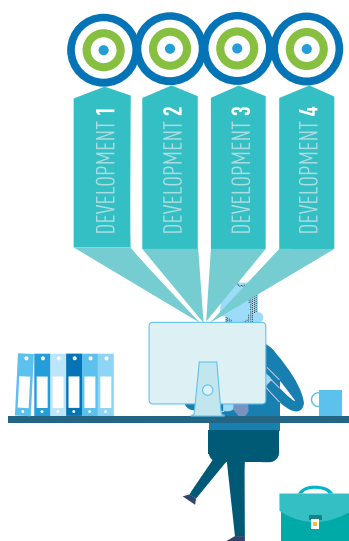

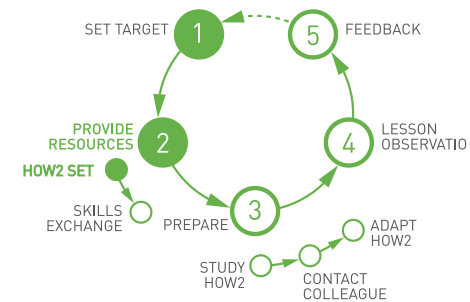
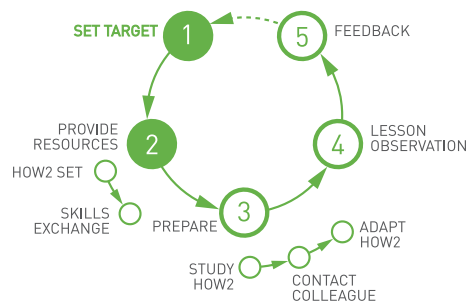

### IDENTIFY TARGETS

As the Lesson Observer, identify areas you want to see developed in your assigned teacher. Write these as targets to be assessed at the next observation.



### MATCH HOW2S TO TARGETS

Provide the teacher with HOW2 solutions to support the targets.

**Create a Set**

NAME  
Ian Harris for coaching

DESCRIPTION  
This set includes the three HOW2s we agreed at our second coaching session. The aim is for Ian to try them out by the end of term.

HOW2S  
Anonymous Assessment X | Which is Which? X | Why is this Good? X

INCLUDE THIS SET IN THE HOW2 LIBRARY FOR ALL OF MY COLLEAGUES

CREATE SET

### CREATE A SET OF HOW2S

Put the suggested HOW2s into a Set and send it to the teacher.

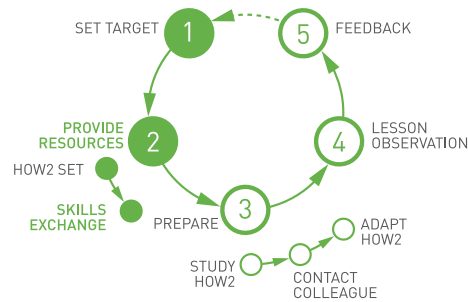

### USE THE SKILLS EXCHANGE

Advise the teacher to use the Skills Exchange to contact a colleague with either the Working On It, or Embedded It Status for support.

**Add Nudge**

TITLE  
Your Status update

DESCRIPTION  
Jan, can you now update your status to Working On It please?

ATTACHMENTS  
Paired Peer Explanation X

ASSIGNED USERS AND GROUPS  
Jan, Harish X

DEADLINE  
13 February, 2015

SAVE NUDES

### STATUS: WORKING ON IT

Remind the teacher to mark her HOW2 Status as Working On It.

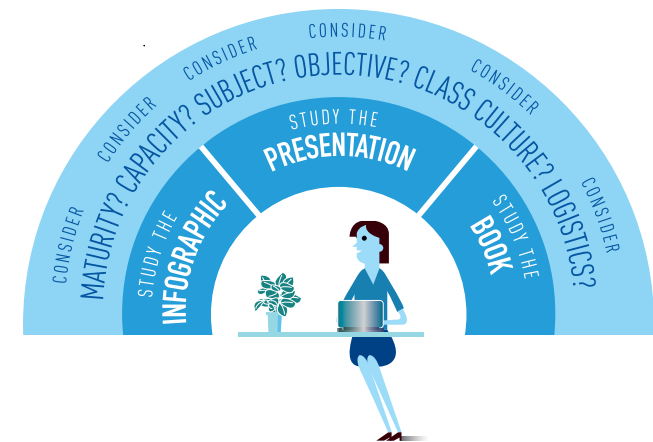

### CONSIDER ADAPTATIONS

The teacher finds your Set of suggested HOW2s when she logs in to the HOW2 app. She then studies the first HOW2 in all three formats, using the Notes to record any potential pitfalls of using the HOW2 as it is without any adaptations for her classes.

LESSON OBSERVATIONS WITH HOW2s

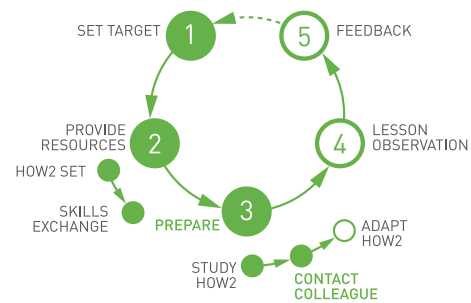

**FIND COLLEAGUES' KNOW-HOW**

The teacher may also contact a colleague for advice, who is identified in the Skills Exchange as having knowhow of the selected HOW2.



**READ COLLEAGUES' NOTES**

The teacher will also read the Notes section to learn from colleagues who have used the HOW2 previously and shared their learning.



**PLAN THE ADAPTATIONS**

The teacher, alone or with the contacted colleague, works to create any necessary adaptations to the HOW2 to suit his class. Plans are placed in the Notes.



### RECORD IMPACT

The teacher trials the HOW2 and its possible adaptations, recording the impact in the Notes.

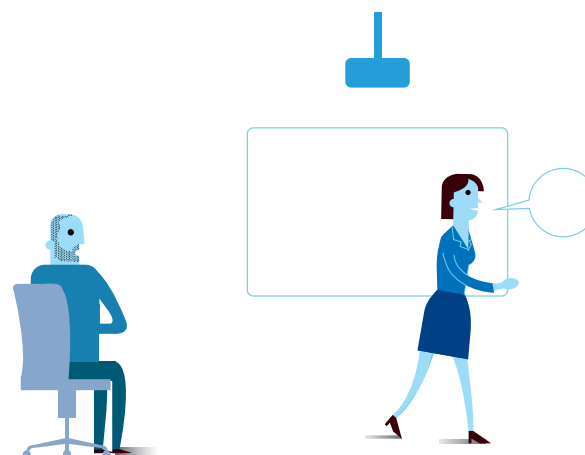

### LESSON OBSERVATION

You now conduct the second lesson observation with the teacher confident having trialed the HOW2 several times previously. Use the same criteria as previously but, this time, also read the teacher's Notes to better understand what is planned.



### FEEDBACK FRAMED BY HOW2

Give the teacher feedback both regarding the formal criteria, but also with your knowledge of the HOW2 plans. This adds a formative element missing from formal observations.

LESSON OBSERVATIONS WITH HOW2s

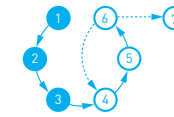
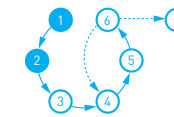
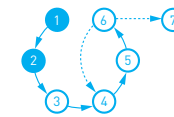
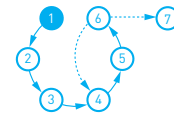
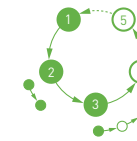
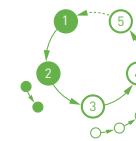
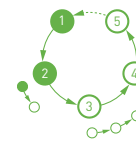

HOW2	PROGRESS	
All One for Take-Off	<input type="checkbox"/> <small>LAST VISITED</small>	<input type="checkbox"/>
Get Feedback	<input type="checkbox"/> <small>LAST VISITED</small>	<input type="checkbox"/>
Describe (writing)	<input type="checkbox"/> <small>LAST VISITED</small>	<input type="checkbox"/>
Go on Visual Instruction Plan	<input type="checkbox"/> <small>LAST VISITED</small>	<input type="checkbox"/>
Go on Document Understanding	<input type="checkbox"/> <small>LAST VISITED</small>	<input type="checkbox"/>

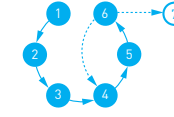
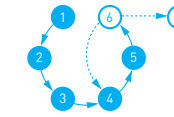
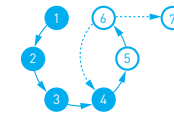
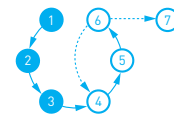
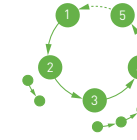
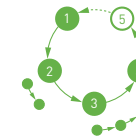
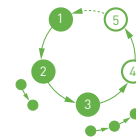

EMBED THE HOW2 IN PRACTICE

If the lesson is successful, direct the teacher to change her HOW2 Status to Embedded It. And encourage her to offer her newly acquired *know-how* to colleagues via the Skills Exchange.

THE HOW2 PROCESS

Whatever the CPD activity, the HOW2 Process applies and aligns to it. Above you see how it matches to the stages of the Lesson Observation process.

